

## 定位器使用指南

### 苹果应用

苹果商城搜索：爱守护



安卓应用



服务平台：[www.gpsui.net](http://www.gpsui.net)

苹果应用：爱守护

安装应用：爱守护

微信公众号：爱守护 GPS

### 一、使用前准备

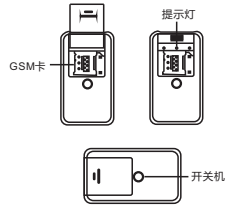

- 1、设备支持移动，联通 2/3/4G 手机卡，物联网卡，不支持 CDMA 电信卡
- 2、选择 GSM 网络 nano sim 卡，需开通 GPRS 上网功能和来电显示
- 3、扫描首页二维码下载“爱守护”手机客户端

### 二、设备功能简介

- 多重定位模式：GPS+AGPS+LBS+WIFI
- 全球通用 GSM+GPRS 四频系统，850/900/1800/1900MHz
- 时间自动更新，GPS 准确授时，无需手动调整时间
- 定位查询：可通过手机 APP 或者电脑查询使用者的具体位置

- 电子围栏：以设备为中心在地图划定一个区域，出入区域马上报警
- 历史轨迹：随时随地查询设备三个月内运行轨迹
- SOS 求救：遇到紧急情况，按下 SOS 键，即对监护人发出求救电话与信息
- 找设备：设备丢失可通过手机 APP 找到设备
- 远程拾音：高灵敏度的麦克风，在使用者出现紧急状况时实时聆听设备周边的声音
- 远程关机：通过监护人手机 APP 可实现设备关机功能
- 远程重启：通过监护人手机 APP 可实现设备重启功能
- 智能省电：通过监护人手机 APP 设定时间范围，设备关闭/打开 GPS 和数据上传

### 三、开机

插入 sim 卡到设备（推动卡槽进行打开和固定，卡座上有方向示意图），长按开机键 3 秒到三个灯亮（卡座旁边黑色按钮为开机键）

**开机：**长按 3 秒

**SOS：**开机状态长按 3 秒

**关机（有 sim 卡）：**长按 10 秒

**关机（无 sim 卡）：**长按 3 秒

### 四、账户登陆

每台设备都有一个银色标签贴纸，为设备的唯一识别码即 IMEI 号，由 7-15 位数字组成，也是 APP 的登陆账户名。打开 APP：

账户 ID：IMEI 号

默认密码：123456

### 五、定位



### 五、拾音与 SOS 求救



#### 5.1 拾音

绑定好 SOS 号码后，使用绑定的号码对设备进行拨打，设备会自动接听，设备端不会出现任何声音。

#### 5.2 SOS 求救

长按开机键 3 秒钟设备会自动拨打设置号码，进行求救。（求救方式可选）

### 六、录音

#### 6.1 APP 录音

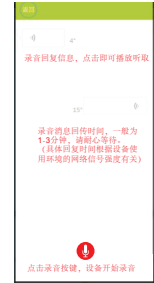

#### 6.2 内存卡录音

内存卡录音只支持带内存卡座的设备：

短信指令 1：定时录音：编辑短信“LY10”发送至设备，设备回复“LY10 OK”则开始录音 10 分钟。（定时录音最高可设置 60 分钟“LY1-LY60”根据需要可任意编辑选择）

短信指令 2：长录音开启：编辑短信“LY”发送至设备。设备回复“LY OK”则开始长时间录音。（开启后如无指令关闭，会自动录音到设备内存文件满盘，或者设备电量耗尽为止）

短信指令 3：关闭长录音：编辑短信“GBLY”发送至设备，设备回复

“GBLYOK”即可关闭录音状态。

（注：读取内存卡录音请取出内存卡，连接电脑进行读取）

### 七、指示灯

**红灯：**电量指示灯，开机快闪，待机灭灯。充电常亮。

**黄灯：**GSM 信号灯，慢闪正常，快闪正在搜信号，待机灭灯。

**蓝灯：**GPS 信号灯，慢闪正常，快闪正在搜信号，待机灭灯。

### 八、短信命令收集

8.1 查询 IMEI 号—发送短信：“imei#”

8.2 恢复出厂密码—发送短信：“pwrst”

8.3 恢复出厂设置—发送短信：“1122”

8.4 设置上传间隔—发送短信：“time#分钟”（分钟可设置 1-120 分钟）：“md#秒”（秒可设置 10-60 秒）

8.5 开启/关闭指示灯—发送短信 “Led#on/Led#off”

8.6 APN 设置—发送短信：“APN#参数#账户#密码#”

8.7 远程重启—发送短信：“sysrst#”

8.8 震动短信报警—发送短信：6666#on#/6666#off#

8.9 修改服务器 IP—发送短信：domain#IP 地址#端口号#

### 九、短信操作令

LY1-LY60（短信录音，发完短信立即根据设置的时间录一次）

LY（长录音开启，直到内存文件存满，或者设备关机）

GBLY（关闭长录音功能）

444（删除内存全部内容）

555（关闭所有功能）

666（震动短信报警，报警短信发送至绑定的手机号，取消发 555）

777（震动电话报警，报警电话回拨给绑定的手机号，取消发 555）

DW（短信定位）

### 五、故障排除

设备首次开机无法连接至服务器，app 发指令显示设备未联网。请检查：

- （1）检查 SIM 卡是否正确插入设备
- （2）设备里面的 SIM 是不是支持 GSM 网络，比如电信就不支持。
- （3）设备里的 SIM 卡是否开通数据流量，必须能兼容 2G 网络的数据流量，设备目前只能使用 2G 的数据流量。
- （4）IMEI 是否正确，必须保证设备贴的 IMEI 条码和设备出厂写入的 IMEI 一致

**法律声明：**此产品开发仅用于个人、公司、运输车队安全守护。

请遵守国家相关法律条文，公司，销售部门不负任何法律责任！

# Locator User Guide

Apple application  
Apple Mall Search:  
Love Guardian

Android app



Service platform: www.gpsui.net  
Apple Application: Love Guardian  
Android application: Love Guardian  
WeChat public number: love guardian GPS

## 1, preparation before use

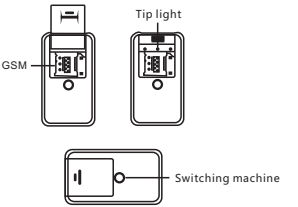

- 1、the device supports mobile, Unicom 2/3/4G mobile phone card, IoT card, does not support CDMA telecommunication card
- 2, select GSM network nano sim card, need to open GPRS Internet access and caller ID
- 3, scan the home page QR code to download «love guardian» mobile client

## 2, the device function introduction

- Multiple positioning mode: GPS+AGPS+LBS+WIFI
- Universal GSM+GPRS quad-band system, 850/900/1800/1900MHz
- Automatic time update, accurate GPS timing, no need to manually adjust the time
- Location query: You can check the user's specific location through mobile app or computer.

Electronic fence: set an area on the map centered on the equipment, and immediately call the area

- Historical trajectory: Query the running trajectory of the device within three months anytime and anywhere
- SOS for help: In case of emergency, press the SOS button to send a call for help and information to the guardian.
- Find equipment: Lost equipment can find equipment through mobile APP
- Remote pickup: A high-sensitivity microphone that listens to the sound around the device in real time when the user has an emergency.
- Remote shutdown: device shutdown function can be realized through the guardian mobile phone APP
- Remote restart: device restart function can be realized through the guardian mobile phone APP
- Intelligent power saving: set the time range through the guardian mobile APP, the device turns off/on GPS and data upload

## 3、Boot

Insert the sim card into the device (push the card slot to open and fix, the card holder has a direction diagram), press and hold the power button for 3 seconds until the three lights are on (the black button next to the card is the power button)  
Power on: long press for 3 seconds  
SOS: Press and hold for 3 seconds  
Shut down (with sim card): long press for 10 seconds  
Shutdown (no sim card): long press for 3 seconds

## 4、 the account login

Each device has a silver label sticker. The unique identifier of the device, the IMEI number, consists of 7-15 digits and is also the login account name of the APP. Open the app:

Account ID: IMEI number  
Default password: 123456

## 5, positioning



Current positioning  
Time and address

equipment status

Display device and mobile phone  
Distance, real-time navigation

## 5、 pickup and SOS for help



### 5.1 pickup

After the SOS number is bound, the device is dialed using the bound number. The device automatically answers and no sound is heard on the device.

### 5.2 SOS for help

Press and hold the power button for 3 seconds, the device will automatically dial the setup number for help.  
(Help mode is optional)

## 6、 recording

### 6.1 APP recording

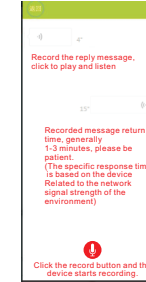

### 6.2 Memory Card Recording

Memory card recording only supports devices with memory card

holders:

SMS command 1: Timed recording: The edit message "LY10" is sent to the device, and the device responds with "LY10 OK" to start recording for 10 minutes. (Timed recording can be set up to 60 minutes "LY1-LY60" can be edited as needed)  
SMS command 2: Long recording on: Edit the message "LY" to send to the device. The device responds with "LY OK" and starts recording for a long time. (If there is no instruction to turn off after turning on, it will automatically record to the device memory file full disk, or the device is exhausted)  
SMS command 3: Turn off long recording: Edit SMS "GBLY" to send to device, device reply

"GBLY OK" will turn off the recording status.  
(Note: Please read the memory card and take out the memory card and connect it to the computer for reading)  
Seven, the indicator light

Red light: Battery indicator, flashing on, flashing off standby. The charge is always on.  
Yellow light: GSM signal light, slow flashing normal, flashing is searching for signal, standby is off.  
Blue light: GPS signal light, slow flashing normal, flashing is searching for signal, standby is off.

## Eight, SMS command collection

- 8.1 Query IMEI Number – Send SMS: "imei#"
  - 8.2 Restore Factory Password—Send SMS: "pwrst"
  - 8.3 Restore factory settings – send SMS: "1122"
  - 8.4 Setting the upload interval—Send SMS: "time#minute" (minutes can be set to 1–120 minutes): "md# seconds" (seconds can be set 10–60 seconds)
  - 8.5 Turning the indicator on/off—Send the text message "Led#on / Led#off"
  - 8.6 APN Settings—Send SMS: "APN#Parameter#Account#Password#"
  - 8.7 Remote Restart – Send SMS: "sysrst#"
  - 8.8 vibration SMS alarm – send SMS: 6666#on# / 6666#off#
  - 8.9 Modify Server IP—Send SMS: domain#IP address#port number#
- Nine, SMS operation order  
LY1–LY60 (SMS recording, immediately after the text message is sent, according to the set time)  
LY (long recording is turned on until the memory file is full, or the device is turned off)  
GBLY (turn off long recording function)  
444 (delete the entire contents of the memory)

- 555 (turn off all features)
- 666 (vibration SMS alarm, alarm message sent to the bound mobile phone number, cancel 555)
- 777 (vibration telephone alarm, alarm call back to the bound mobile phone number, cancel 555)
- DW (SMS targeting)

## Five, troubleshooting

The device cannot be connected to the server when it is turned on for the first time.

Please check:

- (1) Check if the SIM card is correctly inserted into the device.
- (2) Does the SIM in the device support the GSM network, for example, telecommunications does not support it.
- (3) Whether the SIM card in the device is enabled for data traffic must be compatible with the data traffic of the 2G network. Currently, the device can only use 2G data traffic.
- (4) If the IMEI is correct, it must be ensured that the IMEI barcode attached to the device is consistent with the IMEI written by the device.

Legal Notice: This product development is only used for personal, company, and transportation fleet security guards.  
Please comply with relevant national laws and regulations, the company, the sales department does not bear any legal responsibility!